

Characteristics:
 Voltage Rating: 250V
 Current Rating: 15A
 Insulation Resistance: 100MΩ Min. at 500VDC
 Dielectric Strength : AC 500 V Min.at 60s

Material: Brass
 Fuse type: Medium Blade Fuse
 KLS5-270-xxx

Order Information:

L - KLS5 - 718 -X N
 L: RoHS
 Thickness:
 3- T=0.3mm
 4- T=0.4mm
 Plated:
 N-Nickel plated
 T-Tin plated

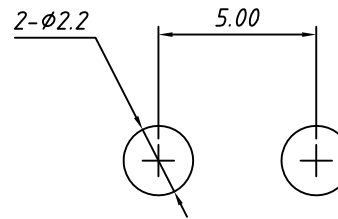

Recommend Mounting Hole

GENERAL TOLERANCE	PROJECTION		Description:	32V Medium Blade
.X ±1.00	UNITS	mm	Fuse Clip, 5.2x0.6mm	
.X ±0.50	SCALE	4:1		
.XX ±0.30	Draw by:	Daniel		
ANGLE TOLERANCE	Check by:	Daniel	KLS P/N:	L-KLS5-718-xx
±5°	Date	2022-09-01		NingBo KLS ELECTRONIC CO.,L TD.
	SHEET	1 OF 1		